

Booking

Reservations only take place with the reservationform, after agreement of the Campsite and in accordance with the limit of the availabilities. The present form must be sended back signed with the deposit, at the latest 4 days, after the date on which the campsite sent these to you. After this term the option will be canceled.

At reception of your reservation and your deposit, we'll send you, in coherence with the available places, a confirmation of reservation. Each accommodation is nominative and can in no case be given up or be rented. Each person not registered in the contract of rent is not authorized to stay, without the permission of the direction. Minors must be accompanied by their parents or legal guardians.

The number of persons that occupies a pitch or mobile home is not allowed to exceed the maximal allowed capacity of 6 persons for a pitch and of 4 till 5 persons for a mobile home according to the type well-defined in the terms of the contract.

Payments conditions

1 - For a pitch booking a 30% deposit of the totalPrice for the ordered services must be remitted (with a minimum deposit of 45 euro). The balance must be payed at arrival, before taking position of the pitch.

2 - For a mobile home booking a 30% deposit of the totalPrice for the ordered services must be remitted, the balance must be payed 30 days before arrival, without this the reservation will be invalid and won't be launched again. Without settlement of the balance within the foresee term, we preserve the right to annul your reservation and the earlier transfered deposit will stay in the possession of the campsite. The payment of the deposit and/or from the Staybalance takes place either by bank transfer or Credit card, Master, Visa. Our IBAN : FR76 16607 00221 0802182861 03, SARL Camping Le Saint Michele, domiciliation Banque Populaire du SUD / address SWIF (BIC) CCBPFRPPPPP

Assignment of the pitches and the mobile homes

Your pitch will only be award on the day of your arrival. We don't reserve pitches side by side, neither if there are specific demands. The arrival takes place after 13h and the departure before 12h.

Your mobile home will just be awarded the day of your arrival in coherence with the reserved category. The arrival takes place after 16h and the departure before 10h.

Alterations and cancellations

Alterations of reservations : Reservations can be changed at the latest 6 weeks before the date of the beginning of the stay or inside the limit of the availabilities on the alteration date.

Too late arrival – earlier departure: In case of too late arrival or from earlier departure due to the mentioned dates on your reservation, won't be no allowance executed no matter what the cause is.

In case of the rent of a pitch, you must warn us WRITTEN about your too late arrival. If we don't receive any information about this subject, than will the pitch be assigned to another client, from the next day at 13 h 00.

Cancellations:

1 – From the side of the Campsite Le Saint Michele : In case of cancellations for a stay through causes caused by ourself, with the exception of cases of superior power which lead us to the cancellation because of security reasons of the tourists, the client will get all the transfered amounts remunerated.

2 - From the side of the camper: In case of dissolution over 30 days before the beginning of the stay, the amount of your deposit will stay property of the Campsite. In case of dissolution less than 30 days before the beginning of the stay, the totalPrice of the stay must be payed. **By these reasons we advise you to conclude a Cancellation Insurance or an Interruption of Stay Insurance.**

Insurances Cancellation or Interruption of Stay

The Cancellation insurance of Interruption of Stay Insurance is not included in the fixed price of the rent. To enjoy from this protection, you've the possibility to conclude an insurance. This one will remunerate you the debit that you're obliged to transfer to us in case of annulation or alteration from your stay, according to our general conditions calculated, with reservation that your case will really be treated.

Damage

The facilities and installations of the campsite must be used in conformance with their common destination. Each damage of the locals, loss or destruction of the furniture elements which garnish the accommodations or the buildings with collective access, obliges the full right of responsibility of its perpetrator. The hiring client official from an accommodation or a pitch is personally responsible for all damage, loss or destructions, caused as well as to the accommodation as to all installations of the campsite, executed by the persons who stay with him/her or who visit him/her. He/she must have a Liability Insurance.

A security from 200 € for the rent of a mobile home must be payed by the tenant at arrival and for the taking in possession of the accommodation for possibly damages and will be refund at the very latest 5 days later after check of the place. The accommodation must be cleaned by you. A fixed amount of 45 € will be retained if the accommodation is not delivered up in the best possible clean status or if the tenant smoked in the mobile home. You'll get automatically the payed security for a stay in mobile homes back if there is no damage established (the return of the keys takes place exclusively Saturdaymorning between 8h and 10h during mean and highseason).

Domestic animal

One single domestic animal is allowed on the field and on condition that it has been given up during the reservation, that it doesn't disturb the calmness and the security of the tourists, and respects the elementarily hygiene rules and the integrity of the installations. It must be kept on a leash and its updated vaccinationbook must possibly can be showed. Domestic animals are not allowed in the swimming pool, on the beach and in the sanitary facilities. Dogs of category 1 and 2 (pitbull, rottweiler...) are not accepted on the campsite. In the mobile homes is **only a domestic animal of little dimension** allowed, it's forbidden to let it climb on the couches and the beds. It's obliged to foresee a basket for it.

Internal regulations, irregularities and nuisance

The payment of the right of visit (tariff visitor: 2€ a person and a day) doesn't open the right for the entrance to the swimming pool which is strictly reserved for the residents of the campsite.

Nocturnal calmness: The residents of the campsite are hold to behave like the internal regulations available at the reception, notably for as for the nocturnal calmness.

Irregularities and nuisance: Each official tenant is responsible for the irregularities and nuisance caused by the persons who stay with him/her. If a resident disturbs other residents or causes irregularities to them or affects the integrity of the installations, his/her stay can immediately be ended without amends, without damage of the applications of reparation which the Campsite and thirds could recoup on his/her costs.

Swimming pool: The swimming pool is subject to own regulations. For security and hygiene rules it's obliged to respect them. **Shorts, boxershorts, bermuda shorts are strictly forbidden.** Only swimming attire is allowed.

Responsibility

The responsibility of the Campsite, further than the legal responsibility doesn't count in case of :

- theft, loss or damage, of which nature it's, during or as a result of a stay.
- nuisance caused by natural phenomena (weather, gnats, aphids, etc. ...)
- defect or discontinuation of technical equipments, defect or closing of campsite installations. Punctual measures, taken by the direction of the campsite, from limitation of the entrance till definite installations, the swimming pool therein included, necessity by the regard of the standards of security of the periodical duties of maintenance. The campsite gives itself on purpose the right to change the conception and the realization of the campsite.
- the security money constitutes no limit of the responsibility, the tenant must have a Liability Insurance.
- each various arising from the interpretation of the execution from the present contract or of its results will be brought to the court of justice of Aubenas (07), only competent.

CAMPING *** <i>Le Saint Michele</i> 2010	Tariffs Mobile homes in € for 4 persons a week from Saturday 16h till Saturday 10h			
	Low season 03/04 till 26/06 28/08 till 06/09	Mean season 26/06 till 03/07 21/08 till 28/08	High season 03/07till10/07 10/07 till 21/08	
	Category 1 : Maximum 4 persons	275	350	410
Category 2 and 3 :	325	400	440	510
Extra Person/week For category 3 only	21	21	35	41.50
Couple	-10%	-10%	⊖	
Animal *	10,50	14	17,50	
Special short stay : minimum 2 nights Tariff in € for 4 persons a day from 15h till 11h				
Category 1 : Capacité 4 pers max	47.50	Exclusively in low season !		
Category 2 and 3	57.50			
Extra Person Cat.3 only	11.50			
Animal *	1,50			
Accommodation tax 2009 a day for a person of +13 years : 0.25 € (will be charged at arrival and can change in 2009)				
Insurance interruption of stay*** 8.80 € a rent contract from Mobile Homes				
Cleaning : 45€				
<p>*1 single domestic animal a mobile home, from small dimension, vaccinated and kept on the leash, dogs of categories 1 and 2 pitbull, rottweiler... not accepted.</p>				

The mobile homes are all "new generation" and are completely equipped: kitchen with refrigerator, gas pits, crockery, coffeepot, micro wave, living room with sofa, bathroom, separate toilets (according to model), one room parents 1 2-pers.bed and a children room 2 or 3 1-pers.beds (according to model) with blanket and pillows. Only sheets must be added to your luggage and to enjoy completely from the nice country air, you have at your disposal a terrace with garden salon.

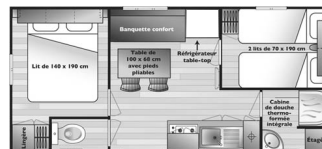

Category 1: 4 places

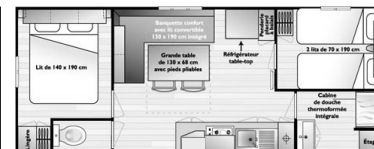

Category 2: 4 places, wide

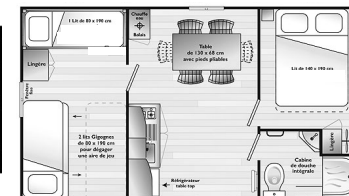

Category 3: 5 places

NB : Dependently from the variety of the models from the mobile homes, it's possible that the plan differs a bit from the internally organisation, every-thing with the same characteristics.

www.lesaintmichelet.com - e-mail: lesaintmichelet@orange.fr
Route de Frigoulet - 30 630 Goudargues
Tel +33 (0)4 66 82 24 99 - Fax +33 (0)4 66 39 56 81

